

FFR 1400

THE DIMENSION TO FIX
(SUGGESTION):
SHAFT: h8

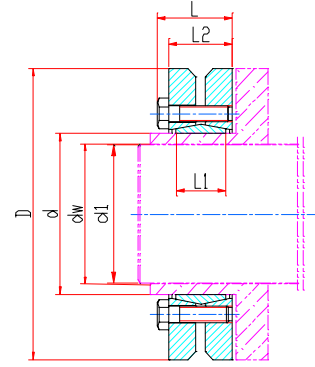

Dimensions							Transmission		Contact Pressure	Locking Screws Din912-12.9		
							Axial Force	Torque	Shaft	Qty.	Size	Tightening Torque
d mm	D mm	dw mm	L1 mm	L2 mm	L mm	C(dw-d1) mm	Ft KN	Mt Nm	P N/mm2			Ts Nm
24	50	19	14	19.5	23	0.017	15.0	170	286.0	6	M5x18	4.9
		20					18.5	210				
		21					21.0	250				
30	60	24	16	21.5	25	0.017	15.7	300	233.0	7	M5x18	4.9
		25					23.7	340				
		26					26.7	380				
36	72	28	18	23.5	27.5	0.032	27.0	440	307.0	5	M6x20	11.8
		30					38.0	570				
		31					43.0	630				
44	80	32	20	25.5	29.5	0.032	44.0	620	317.0	7	M6x20	11.8
		35					49.0	780				
		36					54.0	860				
50	90	38	22	27.5	31.5	0.032	48.8	940	289.0	8	M6x25	11.8
		40					58.8	1160				
		42					69.0	1380				
55	100	42	23	30.5	34.5	0.032	48.0	1160	252.0	8	M6x25	11.8
		45					61.7	1520				
		48					77.0	1880				
62	110	48	23	30.5	34.5	0.048	69.0	1850	279.0	10	M6x25	11.8
		50					80.9	2200				
		52					90.0	2400				
68	115	50	23	30.5	34.5	0.048	71.2	2000	255.0	10	M6x25	11.8
		55					80.9	2500				
		60					95.7	3150				
75	138	55	25	32.5	37.8	0.048	94.4	2500	273.0	7	M8x30	29.4
		60					111.0	3200				
		65					126.0	3950				
80	145	60	25	32.5	37.8	0.048	99.3	3200	256.0	7	M8x30	29.4
		65					115.0	3900				
		70					130.0	4600				
90	155	65	30	39	44.3	0.048	141.0	4750	271.0	10	M8x35	29.4
		70					160.0	6000				
		75					178.0	7250				
100	170	70	34	44	49.3	0.048	163.0	6900	258.0	12	M8x35	29.4
		75					182.0	7500				
		80					202.0	9000				
110	185	75	39	50	56.4	0.048	185.0	7200	244.0	9	M10x40	57.8
		80					207.0	9000				
		85					221.0	10800				
125	215	85	42	54	60.4	0.069	240.0	11000	266.0	12	M10x40	57.8
		90					262.0	13000				
		95					285.0	15000				
140	230	95	46	60.5	68	0.069	308.0	15100	264.0	10	M12x45	98
		100					331.0	17600				
		105					357.0	20100				
155	263	105	50	64.5	72	0.069	366.0	22000	263.0	12	M12x50	98
		110					392.0	25000				
		115					417.0	28000				
165	290	115	56	71	81	0.069	513.0	31000	277.0	8	M16x55	245
		120					544.0	25000				
		125					564.0	39000				