

Set Screw Locking

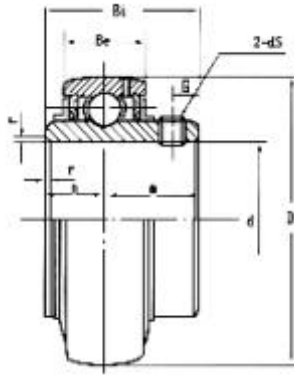

Bearing No.	Bore Dia. of bearing		Dimensions (mm/inch)							Basic Load Rating Lbs/kg	Basic Static Load Rating Lb/kg	Weight	
	d		D	Bi	Be	n	m	G	ds			kg	lbs
	mm	inch											
UC 201	12											0.21	0.46
UC 201-8		1/2										0.21	0.46
UC 202	15											0.19	0.42
UC 202-10		5/8	1.8504	1.2205	0.6299	0.5000	0.7205	0.1969	1/4-28	2230	1390	0.19	0.42
UC 203	17		47	31.0	16	12.7	18.3	5	6x1	1010	630	0.18	0.40
UC 204-12		3/4										0.16	0.35
UC 204	20											0.16	0.35
UC 205-14		7/8										0.23	0.51
UC 205-15		15/16	2.0472	1.3368	0.6693	0.5630	0.7756	0.2165	1/4-28	2420	1560	0.21	0.46
UC 205	25		52	34.0	17	14.3	19.7	5.5	6x1	1100	710	0.20	0.44
UC 205-16		1										0.20	0.44
UC 206-18		1-1/8	2.4409	1.5000	0.7480	0.6260	0.8740	0.2363	5/16-24	3370	2250	0.34	0.75
UC 206	30		52	38.1	19	15.6	22.2	6	8x1	1530	1020	0.32	0.70
UC 206-19		1-3/16										0.32	0.70
UC 207-20		1-1/4										0.54	1.19
UC 207-21		1-5/16										0.51	1.12
UC 207-22		1-3/8	2.8346	1.6890	0.7874	0.6890	1.0000	0.2559	5/16-24	4444	3060	0.48	1.06
UC 207	35		72	42.9	20	17.5	25.4	6.5	8x1	2020	1390	0.48	1.06
UC 207-23		1-7/16										0.45	0.99
UC 208-24		1-1/2										0.68	1.50
UC 208-25		1-9/16	3.1496	1.9370	0.8268	0.7480	1.1890	0.3150	5/16-24	5020	3500	0.65	1.43
UC 208	40		80	49.2	21	19.0	30.2	8	8x1	2280	1290	0.64	1.41
UC 209-26		1-5/8										0.78	1.72
UC 209-27		1-11/16										0.74	1.63
UC 209-28		1-3/4	3.3465	1.9370	0.8661	0.7480	1.1890	0.3150	5/16-24	5630	3980	0.70	1.54
UC 209	45		85	49.2	22	19.0	30.2	8	8x1	2560	1810	0.68	1.50
UC 210-30		1-7/8										0.87	1.91
UC 210-31		1-15/16	3.5433	2.0315	0.9449	0.7480	1.2835	0.3543	3/8-24	6050	4444	0.85	1.80
UC 210	50		90	51.6	24	19.0	32.6	9	2x1	2750	2020	0.80	1.76
UC 211-32		2										1.26	2.77
UC 211-34		2-1/8	3.9370	2.1890	0.9843	0.8740	1.3150	0.3543	3/8-24	7490	5620	1.15	2.53
UC 211	55		100	55.6	25	22.2	33.4	9	10x1.25	3400	2550	1.11	2.44
UC 211-35		2-3/16										1.09	2.40
UC 212-36		2-1/4	4.3307	2.5630	1.0630	1.0000	1.5630	0.4134	3/8-24	9040	6940	1.67	3.67
UC 212	60		110	65.1	27	25.4	39.7	10.5	10x1.25	4100	3150	1.54	3.39
UC 212-38		2-3/8										1.52	3.34
UC 212-39		2-7/16										1.45	3.19
UC 213-40		2-1/2	4.7244	2.5630	1.1024	1.0000	1.5630	0.4727	3/8-24	9920	7590	1.94	4.29
UC 213	65		120	65.1	28	25.4	39.7	12	10x1.25	4500	3450	1.86	4.09