

More size are available upon request

SPZ(For Use with SPZ or Z Belts)

mm

P.D. (P)	No. of Grooves	Bush No.	Pulley Type	F	R	L	P
60	1	1008	2	22		22	
	2	1108	3	49	27	22	
63	1	1108	4	16		22	6
	2	1108	5	28	6	22	
	3	1108	5	40	18	22	
67	1	1108	4	16		22	6
	2	1108	5	28	6	22	
	3	1108	5	40	18	22	
71	1	1108	4	16		22	6
	2	1108	5	28	6	22	
	3	1108	5	40	18	22	
75	1	1108	4	16		22	6
	2	1210	5	28	3	25	
	3	1210	5	40	15	25	
80	1	1210	4	16		25	9
	2	1210	5	28	3	25	
	3	1210	5	40	15	25	
85	1	1210	4	16		25	9
	2	1610	5	28	3	25	
	3	1610	5	40	15	25	
90	1	1210	4	16		25	9
	2	1610	5	28	3	25	
	3	1610	5	40	15	25	
95	1	1210	4	16		25	9
	2	1610	5	28	3	25	
	3	1610	5	40	15	25	
100	1	1210	4	16		25	9
	2	1610	5	28	3	25	
	3	1610	5	40	15	25	
106	1	1610	4	16		25	9
	2	1610	5	28	3	25	
	3	1610	5	40	15	25	
112	1	1610	4	16		25	9
	2	1610	5	28	3	25	
	3	2012	5	40	8	32	
118	1	1610	4	16		25	9
	2	1610	5	28	3	25	
	3	2012	5	40	8	32	
125	1	1610	4	16		25	9
	2	1610	5	28	3	25	
	3	2012	6	40	8	32	
132	1	1610	4	16		25	9
	2	1610	5	28	3	25	
	3	2012	6	40	8	32	

P.D. (P)	No. of Grooves	Bush No.	Pulley Type	F	R	L	P
140	1	1610	4	16		25	9
	2	1610	5	28	3	25	
	3	2012	6	40	8	32	
150	1	1610	4	16		25	9
	2	2012	4	28		32	4
	3	2012	6	40	8	32	
160	1	1610	4	16		25	9
	2	2012	4	28		32	4
	3	2012	6	40	8	32	
170	1	1610	4	16		25	9
	2	2012	4	28		32	4
	3	2012	7	40	4	32	
180	1	1610	8	16		25	9
	2	2012	8	28		32	4
	3	2012	15	40	8	32	
190	1	1610	8	16		25	9
	2	2012	8	28		32	4
	3	2012	9	40	4	32	
200	1	2012	8	16		32	16
	2	2012	8	28		32	4
	3	2012	9	40	4	32	
212	1	2012	8	16		32	16
	2	2012	8	28		32	4
	3	2012	9	40	4	32	
224	1	2012	8	16		32	16
	2	2012	8	28		32	4
	3	2012	9	40	4	32	
250	1	2012	11	16		32	8
	2	2012	11	28		32	2
	3	2012	12	40	4	32	
280	1	2012	10	16		32	8
	2	2012	11	28		32	2
	3	2012	11	40		45	2.5
315	1	2012	10	16		32	8
	2	2012	11	28		32	2
	3	2517	11	40		45	2.5
355	1	2012	11	16		32	8
	2	2012	11	28		32	2
	3	2517	11	40		45	2.5
400	1	2012	11	16		32	8
	2	2517	11	28		45	8.5
	3	2517	11	40		45	2.5
450	2	2517	11	28		45	8
	3	2517	11	40		45	2.5

Pulley Type for SPZ,SPA,SPB and SPC

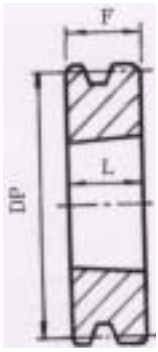

Type 1

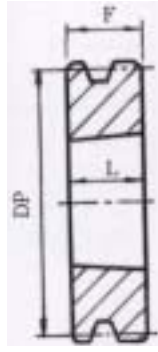

Type 2

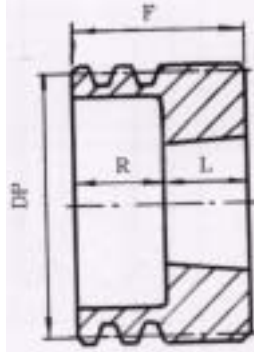

Type 3

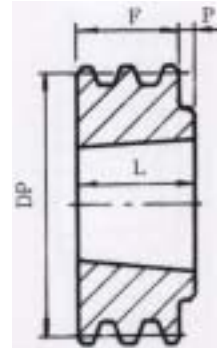

Type 4

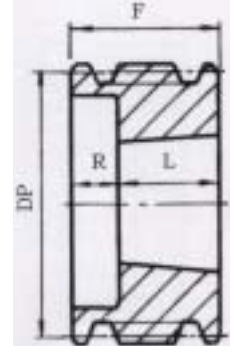

Type 5

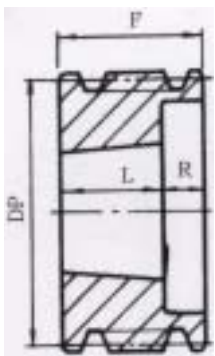

Type 6

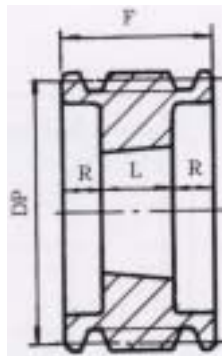

Type 7

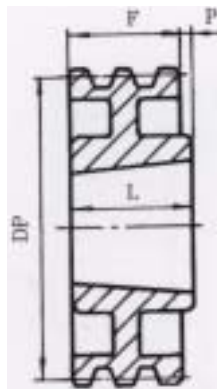

Type 8

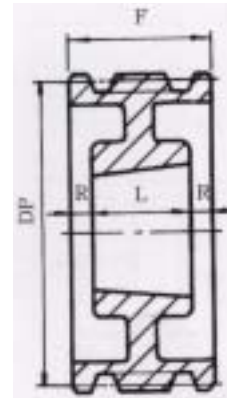

Type 9

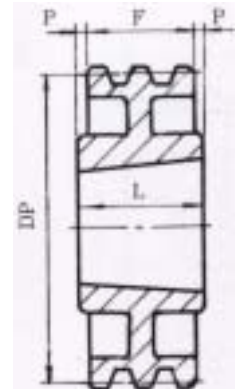

Type 10

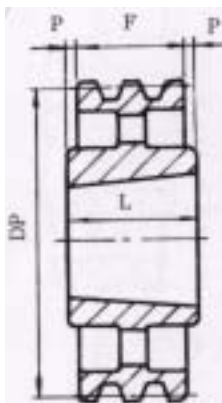

Type 11

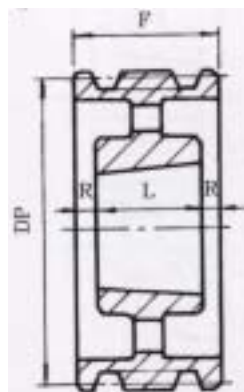

Type 12

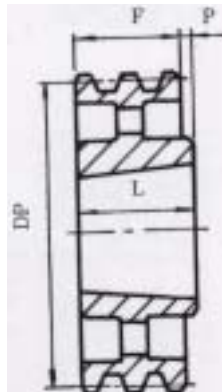

Type 13

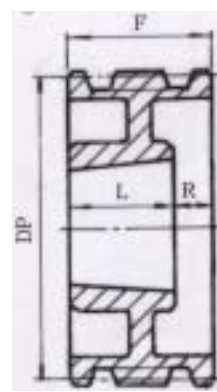

Type 15

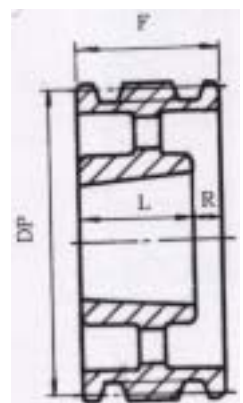

Type 16

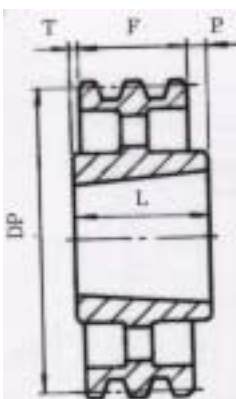

Type 17

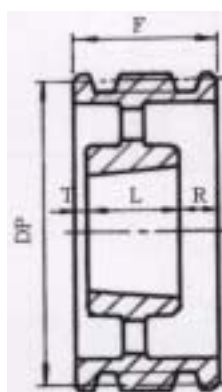

Type 18

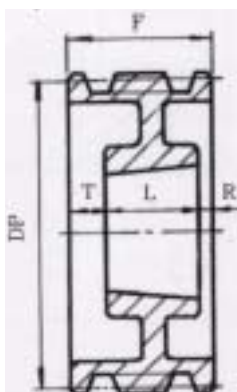

Type 19