

More size are available upon request

SPB(For Use with SPB or B Belts)

mm

P.D. (P)	No. of Grooves	Bush No.	Pulley Type	F	R	L	P
95	2	1210	5	44	19	25	
100	1	1610	1	25		25	
	2	1610	5	44	19	25	
	3	1610	5	63	38	25	
106	1	1610	1	25		25	
	2	1610	5	44	19	25	
	3	1610	5	63	38	25	
112	1	1610	1	25		25	
	2	1610	5	44	19	25	
	3	1610	5	63	38	25	
118	1	1610	1	25		25	
	2	1610	6	44	19	25	
	3	1610	6	63	38	25	
125	1	1610	1	25		25	
	2	2012	6	44	12	32	
	3	2012	6	63	31	32	
	4	2012	7	82	25	32	
132	1	1610	1	25		25	
	2	2012	6	44	12	32	
	3	2012	6	63	31	32	
	4	2012	7	82	25	32	
	5	2517	5	101	56	45	
140	1	1610	1	25		25	
	2	2012	6	44	12	32	
	3	2012	6	63	31	32	
	4	2517	7	82	18.5	45	
	5	2517	7	101	28	45	
150	1	1610	1	25		25	
	2	2012	6	44	12	32	
	3	2517	6	63	18	45	
	4	2517	7	82	18.5	45	
	5	2517	7	101	28	45	
160	1	1610	1	25		25	
	2	2012	6	44	12	32	
	3	2517	6	63	18	45	
	4	2517	7	82	18.5	45	
	5	2517	7	101	28	45	
170	1	1610	1	25		25	
	2	2012	6	44	12	32	
	3	2517	6	63	18	45	
	4	2517	7	82	18.5	45	
	5	3020	7	101	25	51	
180	1	1610	14	25		25	1
	2	2517	4	44		45	
	3	2517	6	63	18	45	
	4	2517	7	82	18.5	45	
	5	3020	7	101	25	51	
190	1	2012	10	25		32	3.5
	2	2517	4	44		45	1
	3	2517	6	63	18	45	
	4	2517	7	82	18.5	45	
	5	3020	7	101	25	51	
200	1	2012	10	25		32	3.5
	2	2517	4	44		45	1
	3	2517	6	63	18	45	
	4	3020	7	82	15.5	51	
	5	3020	7	101	25	51	

P.D. (P)	No. of Grooves	Bush No.	Pulley Type	F	R	L	P
212	1	2012	10	25		32	3.5
	2	2517	8	44		45	1
	3	2517	15	63	18	45	
	4	3020	7	82	15.5	51	
	5	3020	7	101	25	51	
224	1	2012	10	25		32	3.5
	2	2517	8	44		45	1
	3	2517	15	63	18	45	
	4	3020	7	82	15.5	51	
	5	3020	7	101	25	51	
236	1	2012	10	25		32	3.5
	2	2517	8	44		32	1
	3	2517	15	63	18	45	
	4	3020	7	82	15.5	51	
	5	3535	7	101	6	89	
250	1	2012	10	25		32	3.5
	2	2517	8	44		45	1
	3	3020	15	63	12	51	
	4	3020	9	82	15.5	51	
	5	3535	7	101	6	89	
280	1	2012	10	25		32	3.5
	2	2517	8	44		45	1
	3	3020	9	63	6	51	
	4	3020	9	82	15.5	51	
	5	3535	9	101	6	89	
300	1	2012	8	25		32	7
	2	2517	8	44		45	1
	3	3020	9	63	6	51	
	4	3535	8	82		89	7
	5	3535	9	101	6	89	
315	1	2012	10	25		32	3.5
	2	2517	8	44		45	1
	3	3020	9	63	6	51	
	4	3535	10	82		89	3.5
	5	3535	9	101	6	89	
335	2	2517	8	44		45	1
	3	3020	9	63	6	51	
	4	3535	10	82		89	3.5
	5	3535	9	101	6	89	
	355	2	3020	10	44		51
3		3020	9	63	6	51	
4		3535	10	82		89	3.5
5		3535	9	101	6	89	
375		2	3020	10	44		51
	4	3535	10	82		89	3.5
400	2	3020	11	44		51	3.5
	3	3535	11	63		89	13
	4	3535	11	82		89	3.5
	5	3535	12	101	6	89	
	450	2	3020	11	44		51
3		3535	13	63		89	26
4		3535	13	82		89	7
5		3535	16	101	12	89	
500		2	3020	11	44		51
	3	3535	13	63		89	26
	4	3535	13	82		89	7
	5	3535	16	101	12	89	

Pulley Type for SPZ,SPA,SPB and SPC

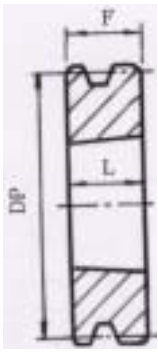

Type 1

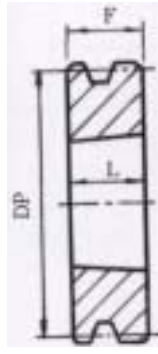

Type 2

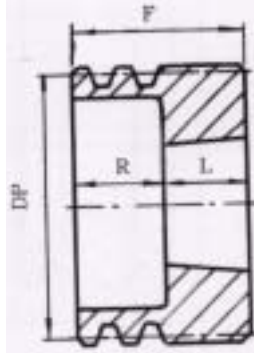

Type 3

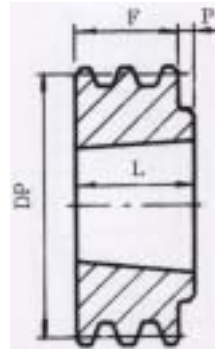

Type 4

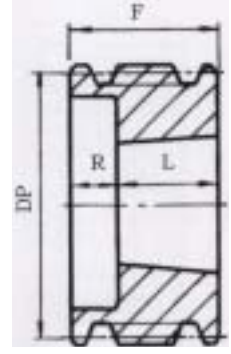

Type 5

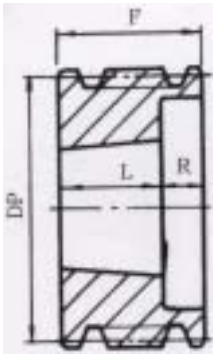

Type 6

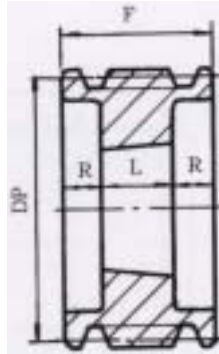

Type 7

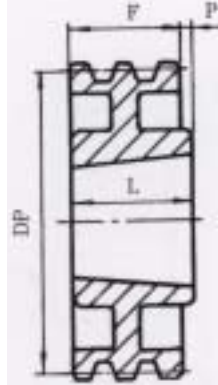

Type 8

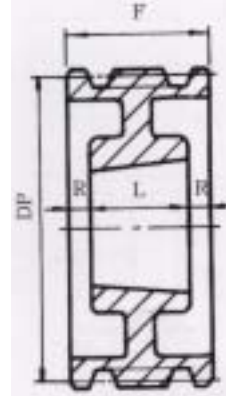

Type 9

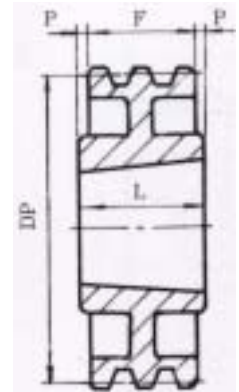

Type 10

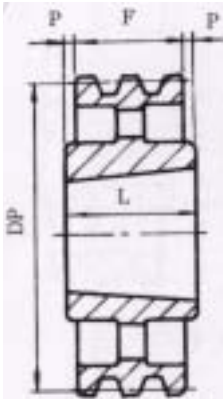

Type 11

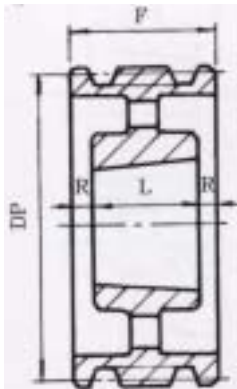

Type 12

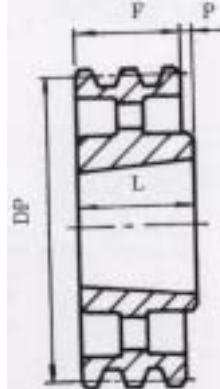

Type 13

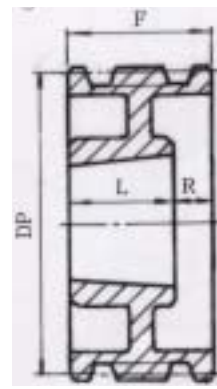

Type 15

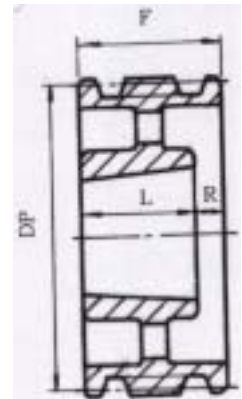

Type 16

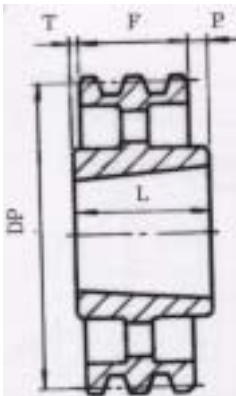

Type 17

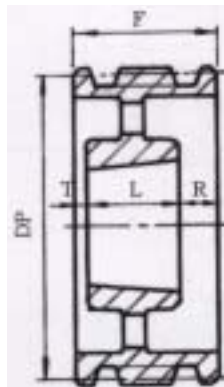

Type 18

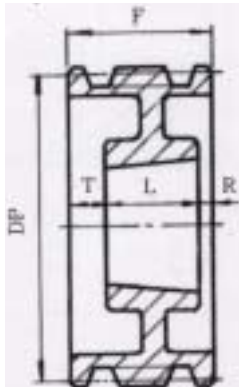

Type 19