

Series: AH2

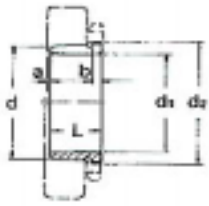

AH3



AH23



AH30

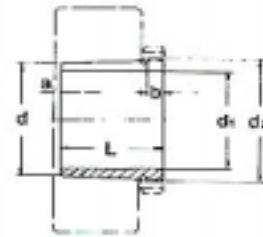

NO.	d	d ₁	L	b	a	d ₂	Weight (kg)
AH 208	40	35	25	6	2	M45 x 1.5	0.081
AH 209	45	40	26	6	3	M50 x 1.5	0.095
AH 210	50	45	28	7	3	M55 x 2	0.114
AH 211	55	50	29	7	3	M60 x 2	0.132
AH 212	60	55	32	8	3	M65 x 2	0.161
AH 213	65	60	32.5	8	3.5	M75 x 2	0.213
AH 214	70	65	33.5	8	3.5	M80 x 2	0.240
AH 215	75	70	34.5	8	3.5	M85 x 2	0.259
AH 216	80	75	35.5	8	3.5	M90 x 2	0.284
AH 217	85	80	38.5	9	3.5	M95 x 2	0.314
AH 218	90	85	40	9	4	M100 x 2	0.351
AH 219	95	90	43	10	4	M105 x 2	0.403
AH 220	100	95	45	10	4	M110 x 2	0.481
AH 222	110	105	50	11	4	M120 x 2	0.547
AH 224	120	115	53	12	4	M130 x 2	0.679
AH 226	130	125	53	12	4	M140 x 2	0.725
AH 228	140	135	56	13	5	M150 x 2	0.818
AH 230	150	145	60	14	5	M160 x 3	0.963
AH 232	160	150	64	15	5	M170 x 3	1.70
AH 234	170	160	69	16	5	M180 x 3	1.98
AH 236	180	170	69	16	5	M190 x 3	2.14
AH 238	190	180	73	17	5	Tr205 x 4	2.52
AH 240	200	190	77	18	5	Tr215 x 4	2.87
AH 244	220	200	85	18	6	Tr235 x 4	5.49
AH 248	240	220	96	22	6	Tr260 x 4	7.34
AH 252	260	240	105	23	6	Tr280 x 4	8.80
AH 256	280	260	105	23	8	Tr300 x 4	9.42
AH 308	40	35	29	6	3	M45 x 1.5	0.090
AH 309	45	40	31	6	3	M50 x 1.5	0.109
AHX 310	50	45	35	7	3	M55 x 2	0.137
AHX 311	55	50	37	7	3	M60 x 2	0.161
AHX 312	60	55	40	8	3	M65 x 2	0.189
AH 313	65	60	42	8	3	M75 x 2	0.253
AH 314	70	65	43	8	4	M80 x 2	0.280
AH 315	75	70	45	8	4	M85 x 2	0.313
AH 316	80	75	48	8	4	M85 x 2	0.365
AHX 317	85	80	52	9	4	M90 x 2	0.429
AHX 318	90	85	53	9	4	M95 x 2	0.461
AHX 319	95	90	57	10	4	M100 x 2	0.532
AHX 320	100	95	59	10	4	M110 x 2	0.582
AHX 322	110	105	63	12	4	M120 x 2	0.663
AHX 324	120	115	69	13	4	M130 x 2	0.866
AHX 326	130	125	74	14	4	M140 x 2	1.02
AHX 328	140	135	77	14	5	M150 x 2	1.16
AHX 330	150	145	83	15	5	M165 x 3	1.50
AH 332	160	150	88	16	5	M180 x 3	2.69
AH 334	170	160	93	17	5	M190 x 3	3.07
AH 2308	40	35	40	7	3	M45 x 1.5	0.128
AH 2309	45	40	44	7	3	M50 x 1.5	0.164

NO.	d	d ₁	L	b	a	d ₂	Weight (kg)
AHX 2310	50	45	50	9	3	M55 x 2	0.209
AHX 2311	55	50	54	10	3	M60 x 2	0.253
AHX 2312	60	55	58	11	3	M65 x 2	0.297
AH 2313	65	60	61	12	3	M75 x 2	0.395
AHX 2314	70	65	64	12	4	M80 x 2	0.466
AHX 2315	75	70	68	12	4	M85 x 2	0.534
AHX 2316	80	75	71	12	4	M90 x 2	0.597
AHX 2317	85	80	74	13	4	M95 x 2	0.670
AHX 2318	90	85	79	14	4	M100 x 2	0.779
AHX 2319	95	90	85	16	4	M105 x 2	0.886
AHX 2320	100	95	90	16	4	M110 x 2	0.998
AHX 2322	110	105	98	16	4	M125 x 2	3.35
AHX 2324	120	115	105	17	4	M135 x 2	1.60
AHX 2326	130	125	115	19	4	M145 x 2	1.97
AHX 2328	140	135	125	20	5	M155 x 3	2.33
AHX 2330	150	145	135	24	5	M165 x 3	2.82
AH 2332	160	150	140	24	6	M180 x 3	4.72
AH 2334	170	160	146	24	6	M190 x 3	5.25
AH 2336	180	170	154	26	6	M200 x 3	5.83
AH 2338	190	180	160	26	7	Tr210 x 4	6.63
AH 2340	200	190	170	30	7	Tr220 x 4	7.54
AH 2344	220	200	181	30	8	Tr240 x 4	13.5
AH 2348	240	220	189	30	8	Tr260 x 4	15.5
AH 2352	260	240	205	30	8	Tr290 x 4	19.6
AH 2356	280	260	212	30	8	Tr310 x 5	21.6
AHX 3024	120	115	60	13	4	M130 x 2	0.750
AHX 3026	130	125	67	14	4	M140 x 2	0.930
AHX 3028	140	135	68	14	5	M150 x 2	1.01
AHX 3030	150	145	72	15	5	M160 x 3	1.15
AH 3032	160	150	77	16	5	M170 x 3	2.06
AH 3034	170	160	85	17	5	M180 x 3	2.43
AH 3036	180	170	92	17	6	M190 x 3	2.81
AH 3038	190	180	96	18	6	Tr205 x 4	3.32
AH 3040	200	190	102	19	6	Tr215 x 4	3.80
AH 3044	220	200	111	20	6	Tr235 x 4	7.40
AH 3048	240	220	116	21	7	Tr260 x 4	8.75
AH 3052	260	240	128	23	7	Tr280 x 4	10.7
AH 3056	280	260	131	24	8	Tr300 x 4	12.0
AH 3060	300	280	145	26	8	Tr320 x 5	14.4
AH 3064	320	300	149	27	8	Tr345 x 5	16.0
AH 3068	340	320	162	28	9	Tr365 x 5	19.5
AH 3072	360	340	167	30	9	Tr385 x 5	21.0
AH 3076	380	360	170	31	10	Tr410 x 5	23.2
AH 3080	400	380	183	33	10	Tr430 x 5	27.3
AH 3084	420	400	186	34	10	Tr450 x 5	29.0
AHX 3088	440	420	194	35	11	Tr470 x 5	32.0
AHX 3092	460	440	202	37	11	Tr490 x 5	35.2
AHX 3096	480	460	205	38	12	Tr520 x 6	39.2